

Workbench Drawer Unit



Communications Trailer

MAXIMUM™

30 1/2" (77.6 cm) W

4-Drawer Base Cabinet



model no. 068-7096-0

IMPORTANT

Please read this manual carefully before assembling and using this cabinet and save it for reference

INSTRUCTION MANUAL

Due to continuing improvements, the actual product may differ slightly from the product described herein.

TABLE OF CONTENTS

SAFETY	3
MAINTENANCE	3
EXPLODED VIEW / PART LIST	4
ASSEMBLY INSTRUCTIONS	5
COORDINATING PRODUCTS	7
WARRANTY	8

NOTE

If any parts are missing or damaged, or if you have any questions, please call 1-888-670-6682 and have the product number, cash register receipt and the date of purchase available when you call. DO NOT SHIP YOUR PRODUCT BACK TO THE STORE, UNLESS WE SEND YOU WRITTEN INSTRUCTIONS FOR RETURN.



SAVE THESE INSTRUCTIONS

This manual contains important safety and operating instructions. Read all instructions and follow carefully them with use of this products

SAFETY

To reduce the risk of serious injury, read and follow the safety instructions below before assembling and using this product.

- This product is intended for indoor use only.
- This product is not designed for commercial nor industrial usage.
- Keep the product on level surfaces. The product could become unstable and it may tip over if stored or moved on an uneven surface, which may cause personal injury, death or product damage.
- Any assembly or maintenance of the product must be carried out by adults only.
- Use at least two people to move, assemble or install this cabinet. Failure to do so can result in personal injury or product damage.
- Wear safety glasses when removing or repositioning the slides. The tool could slip, causing personal injury. Close and lock the drawers before moving the cabinet.
- Check all nuts and bolts periodically for tightness. When required, tighten them again.
- DO NOT alter this product in any manner. For example, do not weld external bar locks or attach electrical and lock equipment. This may cause product damage or personal injury.
- DO NOT stand on the product or lean on the drawers or wood top.
- DO NOT open more than one drawer at a time. The product may become unstable and tip, which may cause personal injury or product damage.
- DO NOT leave children unattended near this product.
Cabinets may tip over if improperly opened.
- DO NOT exceed the following weight limit for this product.
 - Maximum load: 841 lb (380 kg)
 - Maximum load for the wood top: 441 lb (200 kg)
 - Maximum load for each drawer: 100 lb (45 kg)

MAINTENANCE

- Lubricate the slides (twice a year) with a spray lubricant or light duty oil.
- The drawer fronts, other surfaces should be cleaned periodically with a soft rag and water.
- Grease and oil can be removed with most standard cleaning fluids.
For safety, use a nonflammable cleaning fluid.

EXPLODED VIEW / PART LIST

No.	Description	Qty
1	Wood Top	1
2	M6 x 12 Phillips Pan Head Screw *	17
3	Adjustable Foot	4
4	Slide (right)	4
5	Screwdriver	1

No.	Description	Qty
6	Drawer Liner	4
7	Slide (left)	4
8	Key	2
9	Lock	1
10	M6 x 65 Hex Tapping Screw	2

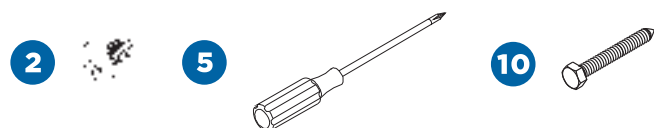

*NOTE: One extra M6 x 12 Phillips pan head screw is provided.

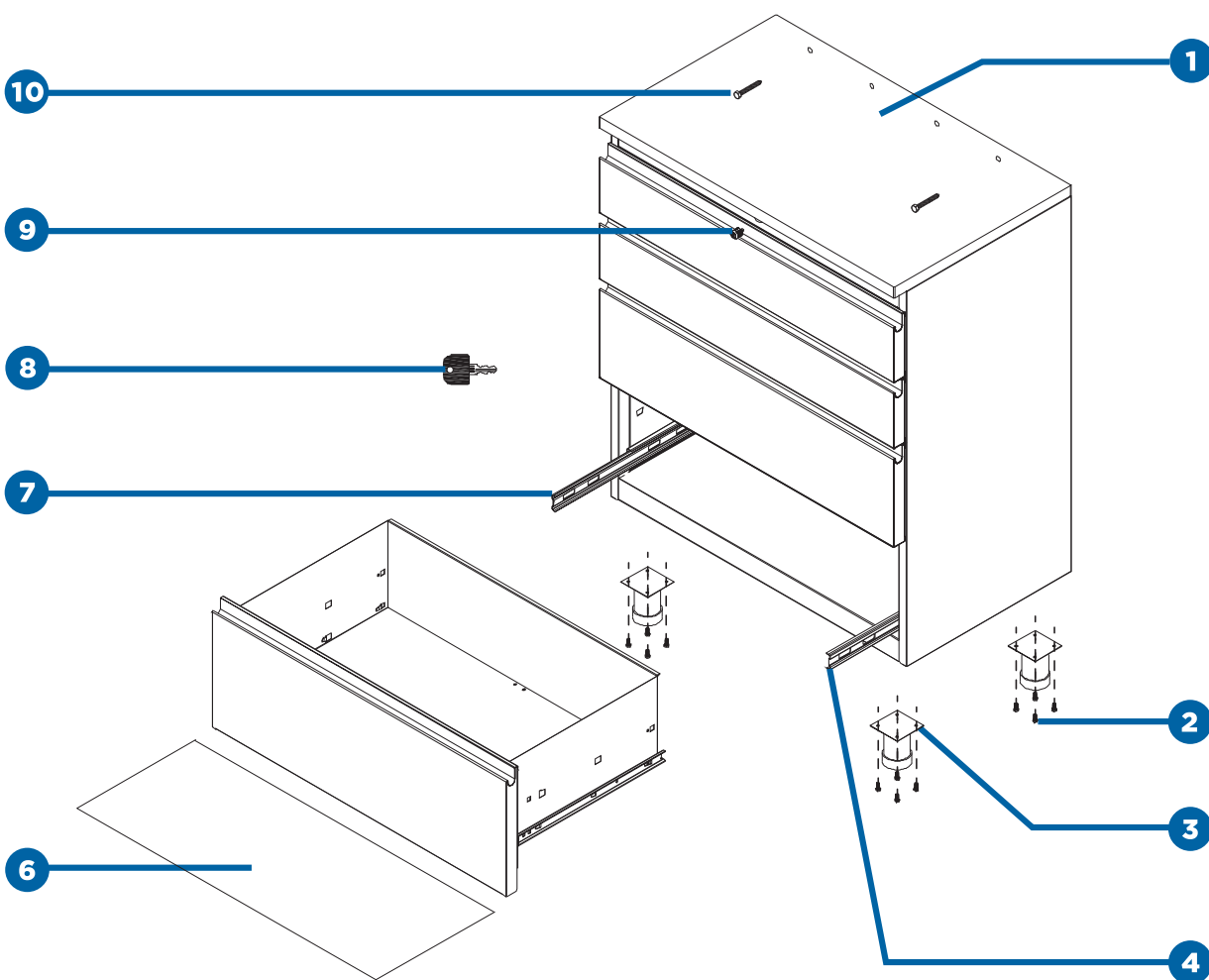
**NOTE:**

Replacement keys may be ordered. Call our toll-free number. The code which appears on the lock will be required.

TOOLS REQUIRED FOR ASSEMBLY

- Screwdriver (5)
- Power drill (not included)

TO INSTALL ADJUSTABLE FEET

Carefully lay the cabinet on its back with a soft mat underneath for protection.

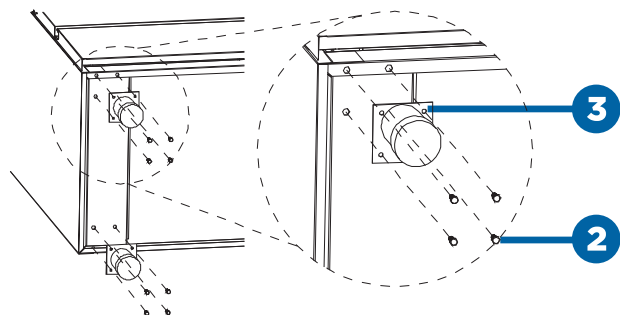

Install the adjustable feet (3) to the cabinet bottom. Make sure the A sides of the adjustable feet are facing either towards the back or the front of the cabinet. Tighten securely with 16 PCS of M6 x 12 Phillips pan head screws (2).

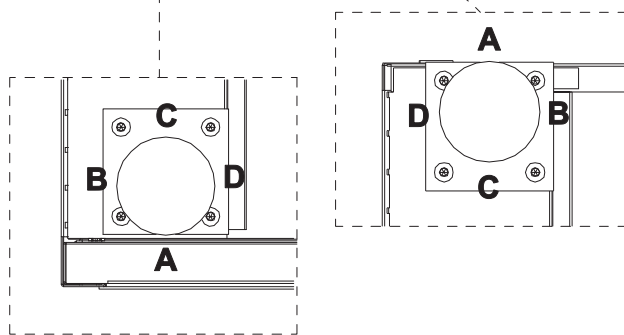
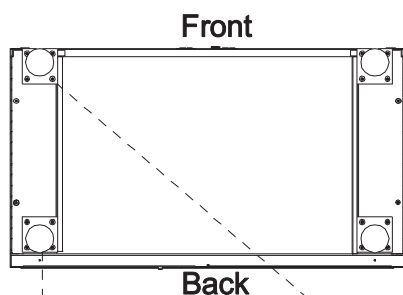

view from under the cabinet

TO REMOVE DRAWER

Pull the drawer out until it is extended to the maximum.

There are two black release levers: one on each side of the drawer. Pull one up while you push the other one down simultaneously. At the same time, pull the drawer out of the drawer slides.

Pull up
(on one side of the drawer)

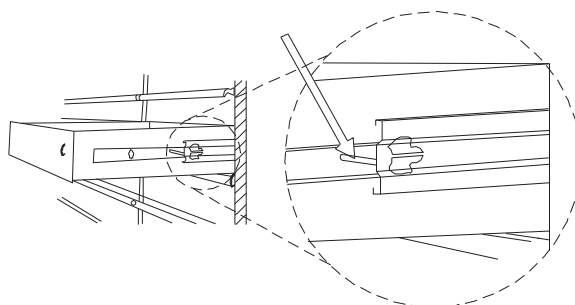

Push down
(on the other side of the drawer)

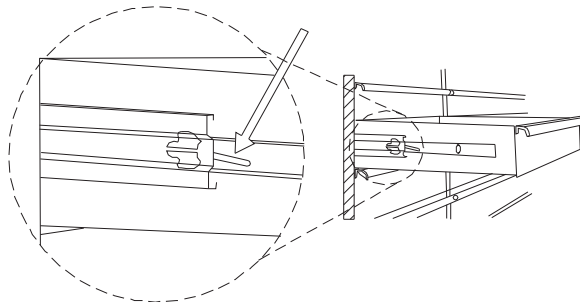

TO REPLACE DRAWERS

Extend the drawer slides from the cabinet.

Insert the brackets on each side of the drawer into the slots in the cabinet slides, being careful that they are properly positioned.

Once properly inserted, completely close the drawer to set the slides in their proper positions.

TO ATTACH THE CABINET TO WALL

Remove the top drawer (as instructed on page 5) from the cabinet.

Place the cabinet on a flat floor against a wall.

Use a power drill to attach the cabinet to the wall with 2 PCS of M6 x 65 hex tapping screws (10) through the holes along the top edge of the back panel. Tighten securely.

For safety, the screws shall be drilled into the studs of the wall.

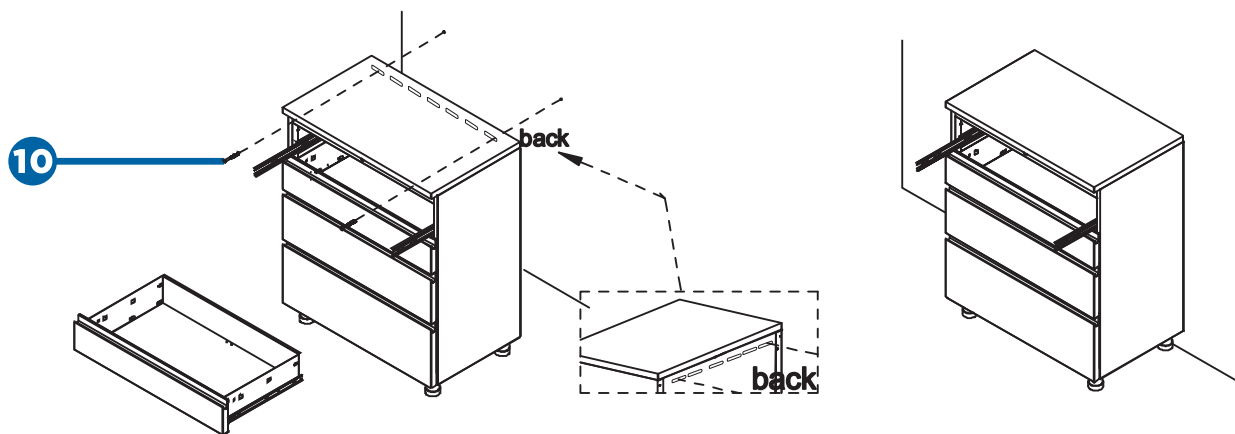

Install the top drawer back (as instructed on page 5) to the cabinet.

The cabinet is ready for use.

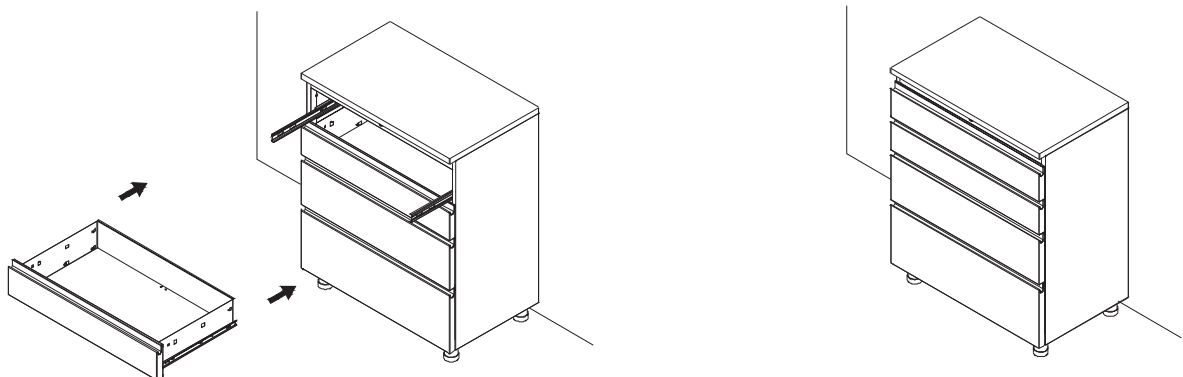

COORDINATING PRODUCTS

This product coordinates well with the units below to offer a best storage solution. They can be combined into various combinations to meet different storage requirements.

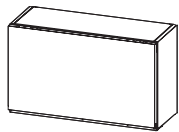
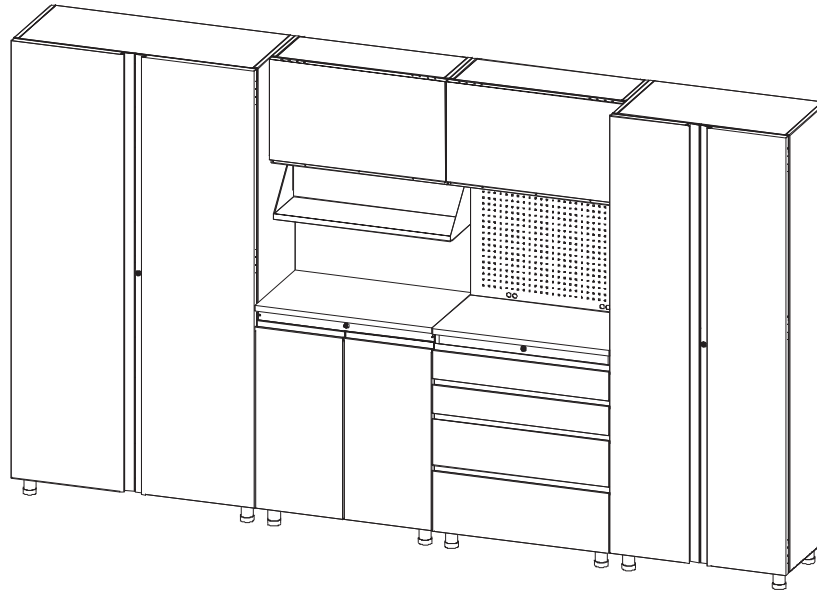

30 1/2" (77.6 cm) wall cabinet
068-7099-4

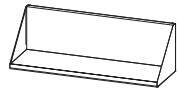

30 1/2" (77.6 cm) shelf
068-7303-8

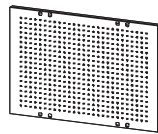

30 1/2" (77.6 cm) peg board
068-7304-6

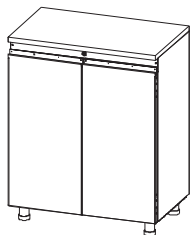

30 1/2" (77.6 cm) 2-door cabinet
068-7095-2

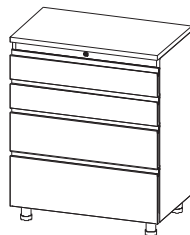

30 1/2" (77.6 cm) 4-drawer cabinet
068-7096-0

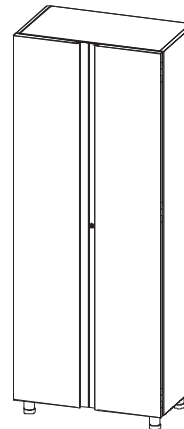

30 1/2" (77.6 cm) tall cabinet
068-7097-8

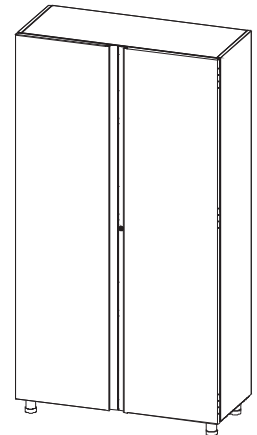

42" (106.8 cm) tall cabinet
068-7098-6

LIMITED WARRANTY

This product is guaranteed for 1 year from the date of original retail purchase against defects in materials and workmanship.

Subject to the conditions and limitations described below, this product, if returned to us with a proof of purchase within the stated warranty period and if covered under this warranty, will be repaired or replaced (with the same model, or one of equal value or specification), at our option. We will bear the cost of any repair or replacement and any costs of labor relating thereto.

This warranty is subject to the following conditions and limitations:

- a) A sales receipt that indicates the date of purchase must be provided;
- b) This warranty will not apply to any product or part thereof which is worn or broken or which has become inoperative due to abuse, misuse, accidental damage, neglect or lack of proper installation, operation or maintenance (as outlined in the applicable owner's manual or operating instructions) or which is being used for industrial, professional, commercial or rental purposes;
- c) This warranty will not apply to normal wear and tear or to expendable parts or accessories that may be supplied with the product that are expected to become inoperative or unusable after a reasonable period of use;
- d) This warranty will not apply to routine maintenance and consumable items such as, but not limited to, fuel, lubricants, vacuum bags, blades, belts, sandpaper, bits, fluids, tune-ups or adjustments;
- e) This warranty will not apply if damage is caused by repairs made or attempted by others (i.e. persons not authorized by the manufacturer);
- f) This warranty will not apply to any product that was sold as a reconditioned or refurbished product (unless otherwise specified in writing);
- g) This warranty will not apply to any product or part thereof if any part from another manufacturer is installed therein or any repairs or alterations have been made or attempted by unauthorized persons;
- h) This warranty will not apply to normal deterioration of the exterior finish, such as, but not limited to, scratches, dents, paint chips, or to any corrosion or discoloring by heat, abrasive and chemical cleaners;
- i) This warranty will not apply to component parts sold by and identified as the product of another company, which shall be covered under the product manufacturer's warranty, if any.

Additional Limitations

This warranty applies only to the original purchaser and may not be transferred. Neither the retailer nor the manufacturer shall be liable for any other expense, loss or damage, including, without limitation, any indirect, incidental, consequential or exemplary damages arising in connection with the sale, use or inability to use this product.

Notice to Consumer

This warranty gives you specific legal rights, and you may have other rights, which may vary from province to province. The provisions contained in this warranty are not intended to limit, modify, take away from, disclaim or exclude any statutory warranties set forth in any applicable provincial or federal legislation.